

30/21 Pulteney Street Adelaide SA

1  1 

This beautiful large one bedroom studio style apartment is sensational, just steps from Rundle Mall - move in or rent out.

View : <https://www.foxrealestate.com.au/property/3021-pulteney-street-adelaide-sa/7204412>

Unique heritage apartment building - circa 1910. Features open plan living/dining, large separate bedroom with east-facing balcony, lounge room with bay window, galley kitchen and spacious bathroom. The apartment is in excellent condition, this is city living at its best, approximately 50m2 in size, with room to enjoy.



Ken Bruce
0407 974 750

This apartment building offers full security entry and foyer, with a wonderful city living lifestyle. The building, "The Ruthven Mansion", was Adelaide's first apartment building. A very spectacular architectural style building with 'Art Nouveau' influence - this is a very classic piece of property

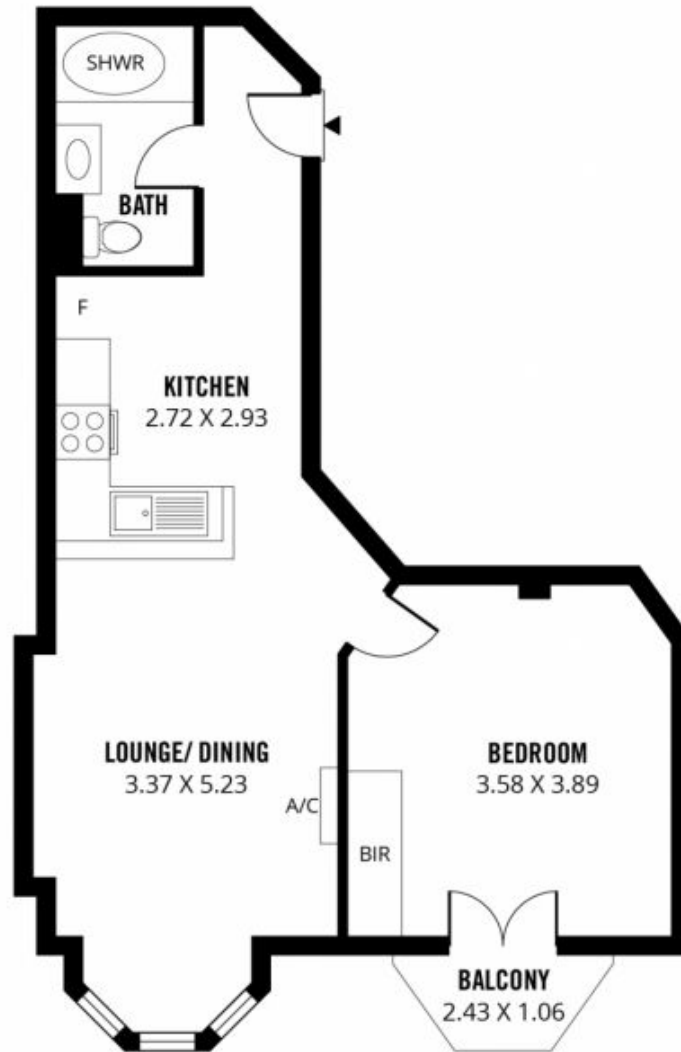

55m²

TOTAL



53m²

Living



2m²

Balcony



Scale in metres. This drawing is for illustration purposes only. All measurements are approximate and details intended to be relied upon should be independently verified. Produced by **The Fotobase Group**